

Application for a premises licence to be granted under the Licensing Act 2003



PLEASE READ THE FOLLOWING INSTRUCTIONS FIRST

Before completing this form please read the guidance notes at the end of the form. If you are completing this form by hand please write legibly in block capitals. In all cases ensure that your answers are inside the boxes and written in black ink. Use additional sheets if necessary.

You may wish to keep a copy of the completed form for your records.

I/We **Pembrokeshire Drinks Ltd**

(Insert name(s) of applicant)

apply for a premises licence under section 17 of the Licensing Act 2003 for the premises described in Part 1 below (the premises) and I/we are making this application to you as the relevant licensing authority in accordance with section 12 of the Licensing Act 2003

Part 1 – Premises details

| | | | |
|--|-------|----------|----------|
| Postal address of premises or, if none, ordnance survey map reference or description | | | |
| The Pavillion, Carew Airfield Sageston | | | |
| Post town | Tenby | Postcode | SA70 8SX |
| | | | |

| | |
|---|---------|
| Telephone number at premises (if any) | |
| Non-domestic rateable value of premises | £19,000 |

Part 2 - Applicant details

Please state whether you are applying for a premises licence as Please tick as appropriate

- | | | |
|--|-------------------------------------|-----------------------------|
| a) an individual or individuals * | <input type="checkbox"/> | please complete section (A) |
| b) a person other than an individual * | | |
| i as a limited company/limited liability partnership | <input checked="" type="checkbox"/> | please complete section (B) |
| ii as a partnership (other than limited liability) | <input type="checkbox"/> | please complete section (B) |
| iii as an unincorporated association or | <input type="checkbox"/> | please complete section (B) |
| iv other (for example a statutory corporation) | <input type="checkbox"/> | please complete section (B) |

- c) a recognised club ☐ please complete section (B)
- d) a charity ☐ please complete section (B)
- e) the proprietor of an educational establishment ☐ please complete section (B)
- f) a health service body ☐ please complete section (B)
- g) a person who is registered under Part 2 of the Care Standards Act 2000 (c14) in respect of an independent hospital in Wales ☐ please complete section (B)
- ga) a person who is registered under Chapter 2 of Part 1 of the Health and Social Care Act 2008 (within the meaning of that Part) in an independent hospital in England ☐ please complete section (B)
- h) the chief officer of police of a police force in England and Wales ☐ please complete section (B)

* If you are applying as a person described in (a) or (b) please confirm (by ticking yes to one box below):

I am carrying on or proposing to carry on a business which involves the use of the premises for licensable activities; or ☒

I am making the application pursuant to a

statutory function or ☐

a function discharged by virtue of Her Majesty's prerogative ☐

(A) INDIVIDUAL APPLICANTS (fill in as applicable)

| | | | | | |
|--|------------------------------|--|-----------------------------|--------------------------------|--|
| Mr <input type="checkbox"/> | Mrs <input type="checkbox"/> | Miss <input type="checkbox"/> | Ms <input type="checkbox"/> | Other Title (for example, Rev) | |
| Surname | | | First names | | |
| Date of birth | | I am 18 years old or over <input type="checkbox"/> | | Please tick yes | |
| Nationality | | | | | |
| Current residential address if different from premises address | | | | | |
| Post town | | | | Postcode | |
| Daytime contact telephone number | | | | | |
| E-mail address (optional) | | | | | |
| Where applicable (if demonstrating a right to work via the Home Office online right to work checking service), the 9-digit 'share code' provided to the applicant by that service (please see note 15 for information) | | | | | |

| |
|--|
| |
|--|

SECOND INDIVIDUAL APPLICANT (if applicable)

| | | | | | |
|---|------------------------------|--|-----------------------------|--------------------------------|--|
| Mr <input type="checkbox"/> | Mrs <input type="checkbox"/> | Miss <input type="checkbox"/> | Ms <input type="checkbox"/> | Other Title (for example, Rev) | |
| Surname | | | First names | | |
| Date of birth | | I am 18 years old or over <input type="checkbox"/> Please tick yes | | | |
| Nationality | | | | | |
| Where applicable (if demonstrating a right to work via the Home Office online right to work checking service), the 9-digit 'share code' provided to the applicant by that service: (please see note 15 for information) | | | | | |
| Current residential address if different from premises address | | | | | |
| Post town | | | | Postcode | |
| Daytime contact telephone number | | | | | |
| E-mail address (optional) | | | | | |

(B) OTHER APPLICANTS

Please provide name and registered address of applicant in full. Where appropriate please give any registered number. In the case of a partnership or other joint venture (other than a body corporate), please give the name and address of each party concerned.

| |
|--|
| Name Pembrokeshire Drinks Ltd |
| Address Kidbraesons Jameston Tenby Pembrokeshire SA70 8QE |
| Registered number (where applicable) 05038595 |

Description of applicant (for example, partnership, company, unincorporated association etc.)
Limited Company

Telephone number (if any)
01834 871923

E-mail address (optional)

Part 3 Operating Schedule

When do you want the premises licence to start?

DD MM YYYY

1 7 0 4 2 0 2 0

If you wish the licence to be valid only for a limited period,
when do you want it to end?

DD MM YYYY

1 9 0 4 2 0 2 0

Please give a general description of the premises (please read guidance note 1)

Premises is a large industrial building situated at a disused airfield.

There is ample parking and facilities in the surrounding area of the building.

Application for capacity of 2000.

If 5,000 or more people are expected to attend the premises at any
one time, please state the number expected to attend.

n/a

What licensable activities do you intend to carry on from the premises?

(please see sections 1 and 14 and Schedules 1 and 2 to the Licensing Act 2003)

Provision of regulated entertainment (please read guidance note 2)

Please tick all that
apply

- a) plays (if ticking yes, fill in box A) ☐
- b) films (if ticking yes, fill in box B) ☐
- c) indoor sporting events (if ticking yes, fill in box C) ☐
- d) boxing or wrestling entertainment (if ticking yes, fill in box D) ☐
- e) live music (if ticking yes, fill in box E) ☒

- f) recorded music (if ticking yes, fill in box F) ☒
- g) performances of dance (if ticking yes, fill in box G) ☒
- h) anything of a similar description to that falling within (e), (f) or (g)
(if ticking yes, fill in box H) ☐

Provision of late night refreshment (if ticking yes, fill in box I) ☒

Supply of alcohol (if ticking yes, fill in box J) ☒

In all cases complete boxes K, L and M

A

| | | | | | |
|---|-------|--------|--|----------|--------------------------|
| Plays Standard days and timings (please read guidance note 7) | | | Will the performance of a play take place indoors or outdoors or both – please tick (please read guidance note 3) | Indoors | <input type="checkbox"/> |
| | | | | Outdoors | <input type="checkbox"/> |
| | | | | Both | <input type="checkbox"/> |
| Day | Start | Finish | | | |
| Mon | | | <u>Please give further details here</u> (please read guidance note 4) | | |
| | | | | | |
| Tue | | | | | |
| | | | | | |
| Wed | | | <u>State any seasonal variations for performing plays</u> (please read guidance note 5) | | |
| | | | | | |
| Thur | | | | | |
| | | | | | |
| Fri | | | <u>Non standard timings. Where you intend to use the premises for the performance of plays at different times to those listed in the column on the left, please list</u> (please read guidance note 6) | | |
| | | | | | |
| Sat | | | | | |
| | | | | | |
| Sun | | | | | |
| | | | | | |

B

| | | | | | |
|---|-------|--------|---|----------|--------------------------|
| Films Standard days and timings (please read guidance note 7) | | | Will the exhibition of films take place indoors or outdoors or both – please tick (please read guidance note 3) | Indoors | <input type="checkbox"/> |
| | | | | Outdoors | <input type="checkbox"/> |
| | | | | Both | <input type="checkbox"/> |
| Day | Start | Finish | | | |
| Mon | | | Please give further details here (please read guidance note 4) | | |
| | | | | | |
| Tue | | | | | |
| | | | | | |
| Wed | | | State any seasonal variations for the exhibition of films (please read guidance note 5) | | |
| | | | | | |
| Thur | | | | | |
| | | | | | |
| Fri | | | Non standard timings. Where you intend to use the premises for the exhibition of films at different times to those listed in the column on the left, please list (please read guidance note 6) | | |
| | | | | | |
| Sat | | | | | |
| | | | | | |
| Sun | | | | | |
| | | | | | |

C

| | | | |
|--|-------|--------|---|
| Indoor sporting events Standard days and timings (please read guidance note 7) | | | <u>Please give further details</u> (please read guidance note 4) |
| Day | Start | Finish | |
| Mon | | | |
| Tue | | | <u>State any seasonal variations for indoor sporting events</u> (please read guidance note 5) |
| Wed | | | |
| Thur | | | <u>Non standard timings. Where you intend to use the premises for indoor sporting events at different times to those listed in the column on the left, please list</u> (please read guidance note 6) |
| Fri | | | |
| Sat | | | |
| Sun | | | |

D

| | | | | | |
|--|-------|--------|---|----------|--------------------------|
| Boxing or wrestling entertainments Standard days and timings (please read guidance note 7) | | | Will the boxing or wrestling entertainment take place indoors or outdoors or both – please tick (please read guidance note 3) | Indoors | <input type="checkbox"/> |
| | | | | Outdoors | <input type="checkbox"/> |
| | | | | Both | <input type="checkbox"/> |
| Day | Start | Finish | | | |
| Mon | | | Please give further details here (please read guidance note 4) | | |
| | | | | | |
| Tue | | | | | |
| | | | | | |
| Wed | | | State any seasonal variations for boxing or wrestling entertainment (please read guidance note 5) | | |
| | | | | | |
| Thur | | | | | |
| | | | | | |
| Fri | | | Non standard timings. Where you intend to use the premises for boxing or wrestling entertainment at different times to those listed in the column on the left, please list (please read guidance note 6) | | |
| | | | | | |
| Sat | | | | | |
| | | | | | |
| Sun | | | | | |
| | | | | | |

E

| | | | | | |
|--|-------|--------|---|----------|-------------------------------------|
| Live music Standard days and timings (please read guidance note 7) | | | <u>Will the performance of live music take place indoors or outdoors or both – please tick</u> (please read guidance note 3) | Indoors | <input checked="" type="checkbox"/> |
| | | | | Outdoors | <input type="checkbox"/> |
| | | | | Both | <input type="checkbox"/> |
| Day | Start | Finish | | | |
| Mon | | | <u>Please give further details here</u> (please read guidance note 4) Live bands with instruments and singers, amplified. | | |
| Tue | | | | | |
| Wed | | | <u>State any seasonal variations for the performance of live music</u> (please read guidance note 5) N/A | | |
| Thur | | | | | |
| Fri | 1900 | 0100 | <u>Non standard timings. Where you intend to use the premises for the performance of live music at different times to those listed in the column on the left, please list</u> (please read guidance note 6) N/A | | |
| Sat | 1900 | 0100 | | | |
| Sat / Sun | | | | | |

F

| | | | | | |
|--|-------|--------|---|----------|-------------------------------------|
| Recorded music Standard days and timings (please read guidance note 7) | | | <u>Will the playing of recorded music take place indoors or outdoors or both – please tick</u> (please read guidance note 3) | Indoors | <input checked="" type="checkbox"/> |
| | | | | Outdoors | <input type="checkbox"/> |
| | | | | Both | <input type="checkbox"/> |
| Day | Start | Finish | | | |
| Mon | | | <u>Please give further details here</u> (please read guidance note 4) Peaky Blinder DJ, playing recorded music | | |
| Tue | | | | | |
| Wed | | | <u>State any seasonal variations for the playing of recorded music</u> (please read guidance note 5) N/A | | |
| Thur | | | | | |
| Fri | 1800 | 0100 | <u>Non standard timings. Where you intend to use the premises for the playing of recorded music at different times to those listed in the column on the left, please list</u> (please read guidance note 6) N/A | | |
| Sat | 1800 | 0100 | | | |
| Sat/ Sun | | | | | |

G

| | | | | | |
|---|-------|--------|--|----------|-------------------------------------|
| Performances of dance Standard days and timings (please read guidance note 7) | | | <u>Will the performance of dance take place indoors or outdoors or both – please tick</u> (please read guidance note 3) | Indoors | <input checked="" type="checkbox"/> |
| | | | | Outdoors | <input type="checkbox"/> |
| | | | | Both | <input type="checkbox"/> |
| Day | Start | Finish | | | |
| Mon | | | <u>Please give further details here</u> (please read guidance note 4) On stage dancer performance in the Peaky Blinder era and style such as burlesque. | | |
| Tue | | | | | |
| Wed | | | <u>State any seasonal variations for the performance of dance</u> (please read guidance note 5) N/A | | |
| Thur | | | | | |
| Fri | | | <u>Non standard timings. Where you intend to use the premises for the performance of dance at different times to those listed in the column on the left, please list</u> (please read guidance note 6) N/A | | |
| Sat | 1900 | 0100 | | | |
| Sun | | | | | |

H

| | | | | | |
|--|-------|--------|--|----------|--------------------------|
| Anything of a similar description to that falling within (e), (f) or (g) Standard days and timings (please read guidance note 7) | | | Please give a description of the type of entertainment you will be providing | | |
| Day | Start | Finish | <u>Will this entertainment take place indoors or outdoors or both – please tick</u> (please read guidance note 3) | Indoors | <input type="checkbox"/> |
| Mon | | | | Outdoors | <input type="checkbox"/> |
| | | | | Both | <input type="checkbox"/> |
| Tue | | | <u>Please give further details here</u> (please read guidance note 4) | | |
| | | | | | |
| Wed | | | | | |
| | | | | | |
| Thur | | | <u>State any seasonal variations for entertainment of a similar description to that falling within (e), (f) or (g)</u> (please read guidance note 5) | | |
| | | | | | |
| Fri | | | | | |
| | | | | | |
| Sat | | | <u>Non standard timings. Where you intend to use the premises for the entertainment of a similar description to that falling within (e), (f) or (g) at different times to those listed in the column on the left, please list</u> (please read guidance note 6) | | |
| | | | | | |
| Sun | | | | | |
| | | | | | |

I

| | | | | | |
|--|-------|--------|--|----------|-------------------------------------|
| Late night refreshment Standard days and timings (please read guidance note 7) | | | Will the provision of late night refreshment take place indoors or outdoors or both – please tick (please read guidance note 3) | Indoors | <input type="checkbox"/> |
| | | | | Outdoors | <input type="checkbox"/> |
| Day | Start | Finish | | Both | <input checked="" type="checkbox"/> |
| Mon | | | <u>Please give further details here</u> (please read guidance note 4) The supply of hot food and beverages | | |
| Tue | | | | | |
| Wed | | | <u>State any seasonal variations for the provision of late night refreshment</u> (please read guidance note 5) N/A | | |
| Thur | | | | | |
| Fri | 2300 | 0100 | <u>Non standard timings. Where you intend to use the premises for the provision of late night refreshment at different times, to those listed in the column on the left, please list</u> (please read guidance note 6) N/A | | |
| Sat | 2300 | 0100 | | | |
| Sun | | | | | |

J

| | | | | | |
|---|-------|--------|---|------------------|-------------------------------------|
| Supply of alcohol Standard days and timings (please read guidance note 7) | | | Will the supply of alcohol be for consumption – please tick (please read guidance note 8) | On the premises | <input type="checkbox"/> |
| | | | | Off the premises | <input type="checkbox"/> |
| | | | | Both | <input checked="" type="checkbox"/> |
| Day | Start | Finish | State any seasonal variations for the supply of alcohol (please read guidance note 5) N/A | | |
| Mon | | | | | |
| Tue | | | | | |
| Wed | | | | | |
| Thur | | | | | |
| Fri | 1800 | 0100 | | | |
| Sat | 1800 | 0100 | | | |
| Sun | | | Non standard timings. Where you intend to use the premises for the supply of alcohol at different times to those listed in the column on the left, please list (please read guidance note 6) | | |
| | | | | | |

State the name and details of the individual whom you wish to specify on the licence as designated premises supervisor (Please see declaration about the entitlement to work in the checklist at the end of the form):

| | |
|--|--|
| Name Phillip Kidney | |
| Date of birth | |
| Address | |
| | |
| Postcode | |
| Personal licence number (if known) | |
| PEMBS/PERS/N | |
| Issuing licensing authority (if known) | |
| Pembrokeshire County Council | |

K

Please highlight any adult entertainment or services, activities, other entertainment or matters ancillary to the use of the premises that may give rise to concern in respect of children (please read guidance note 9).

There will not be any adult entertainment that will give rise for concern in respect of children.

No Person under 18 years of age allowed on the premises.

L

| | | | |
|---|-------|--------|--|
| Hours premises are open to the public Standard days and timings (please read guidance note 7) | | | <u>State any seasonal variations</u> (please read guidance note 5) |
| Day | Start | Finish | |
| Mon | | | <u>Non standard timings. Where you intend the premises to be open to the public at different times from those listed in the column on the left, please list</u> (please read guidance note 6) |
| | | | |
| Tue | | | |
| | | | |
| Wed | | | |
| | | | |
| Thur | | | |
| | | | |
| Fri | 1800 | 0130 | |
| | | | |
| Sat | 1800 | 0130 | |
| | | | |
| Sun | | | |
| | | | |

M

Describe the steps you intend to take to promote the four licensing objectives:

a) General – all four licensing objectives (b, c, d and e) (please read guidance note 10)

Please see appendix A

b) The prevention of crime and disorder

Please see appendix B

c) Public safety

Please see appendix C

d) The prevention of public nuisance

Please see appendix D

e) The protection of children from harm

Please see appendix E

Checklist:

Please tick to indicate agreement

- I have made or enclosed payment of the fee. ☒
- I have enclosed the plan of the premises. ☒
- I have sent copies of this application and the plan to responsible authorities and others where applicable. ☐
- I have enclosed the consent form completed by the individual I wish to be designated premises supervisor, if applicable. ☒
- I understand that I must now advertise my application. ☒
- I understand that if I do not comply with the above requirements my application will be rejected. ☒
- [Applicable to all individual applicants, including those in a partnership which is not a limited liability partnership, but not companies or limited liability partnerships] I have included documents demonstrating my entitlement to work in the United Kingdom or my share code issued by the Home Office online right to work checking service (please read note 15). ☐

IT IS AN OFFENCE, UNDER SECTION 158 OF THE LICENSING ACT 2003, TO MAKE A FALSE STATEMENT IN OR IN CONNECTION WITH THIS APPLICATION. THOSE WHO MAKE A FALSE STATEMENT MAY BE LIABLE ON SUMMARY CONVICTION TO A FINE OF ANY AMOUNT.

IT IS AN OFFENCE UNDER SECTION 24B OF THE IMMIGRATION ACT 1971 FOR A PERSON TO WORK WHEN THEY KNOW, OR HAVE REASONABLE CAUSE TO BELIEVE, THAT THEY ARE DISQUALIFIED FROM DOING SO BY REASON OF THEIR IMMIGRATION STATUS. THOSE WHO EMPLOY AN ADULT WITHOUT LEAVE OR WHO IS SUBJECT TO CONDITIONS AS TO EMPLOYMENT WILL BE LIABLE TO A CIVIL PENALTY UNDER SECTION 15 OF THE IMMIGRATION, ASYLUM AND NATIONALITY ACT 2006 AND PURSUANT TO SECTION 21 OF THE SAME ACT, WILL BE COMMITTING AN OFFENCE WHERE THEY DO SO IN THE KNOWLEDGE, OR WITH REASONABLE CAUSE TO BELIEVE, THAT THE EMPLOYEE IS DISQUALIFIED.

Part 4 – Signatures (please read guidance note 11)

Signature of applicant or applicant's solicitor or other duly authorised agent (see guidance note 12). **If signing on behalf of the applicant, please state in what capacity.**

| | |
|--------------------|---|
| Declaration | <ul style="list-style-type: none">• [Applicable to individual applicants only, including those in a partnership which is not a limited liability partnership] I understand I am not entitled to be issued with a licence if I do not have the entitlement to live and work in the UK (or if I am subject to a condition preventing me from doing work relating to the carrying on of a licensable activity) and that my licence will become invalid if I cease to be entitled to live and work in the UK (please read guidance note 15).• The DPS named in this application form is entitled to work in the UK (and is not subject to conditions preventing him or her from doing work relating to a licensable activity) and I have seen a copy of his or |
|--------------------|---|

| | |
|-----------|--|
| | her proof of entitlement to work, or have conducted an online right to work check using the Home Office online right to work checking service which confirmed their right to work (please see note 15) |
| Signature |  |
| Date | 23/01/2020 |
| Capacity | Managing Director |

For joint applications, signature of 2nd applicant or 2nd applicant's solicitor or other authorised agent (please read guidance note 13). If signing on behalf of the applicant, please state in what capacity.

| | |
|-----------|--|
| Signature | |
| Date | |
| Capacity | |

Contact name (where not previously given) and postal address for correspondence associated with this application (please read guidance note 14)



| | | | |
|---|--|----------|--|
| Post town | | Postcode | |
| Telephone number (if any) | | | |
| If you would prefer us to correspond with you by e-mail, your e-mail address (optional) | | | |
| info@absoluteeventbars.co.uk | | | |

Notes for Guidance

1. Describe the premises, for example the type of premises, its general situation and layout and any other information which could be relevant to the licensing objectives. Where your application includes off-supplies of alcohol and you intend to provide a place for consumption of these off-supplies, you must include a description of where the place will be and its proximity to the premises.
2. In terms of specific regulated entertainments please note that:
 - Plays: no licence is required for performances between 08:00 and 23.00 on any day, provided that the audience does not exceed 500.
 - Films: no licence is required for 'not-for-profit' film exhibition held in community premises between 08.00 and 23.00 on any day provided that the audience does not exceed 500 and the organiser (a) gets consent to the screening from a person who is responsible for the premises; and (b) ensures that each such screening abides by age classification ratings.
 - Indoor sporting events: no licence is required for performances between 08.00 and 23.00 on any day, provided that the audience does not exceed 1000.
 - Boxing or Wrestling Entertainment: no licence is required for a contest, exhibition or display of Greco-Roman wrestling, or freestyle wrestling between 08.00 and 23.00 on any day, provided that the audience does not exceed 1000. Combined fighting sports – defined as a contest, exhibition or display which combines boxing or wrestling with one or more martial arts – are licensable as a boxing or wrestling entertainment rather than an indoor sporting event.
 - Live music: no licence permission is required for:
 - a performance of unamplified live music between 08.00 and 23.00 on any day, on any premises.
 - a performance of amplified live music between 08.00 and 23.00 on any day on premises authorised to sell alcohol for consumption on those premises, provided that the audience does not exceed 500.
 - a performance of amplified live music between 08.00 and 23.00 on any day, in a workplace that is not licensed to sell alcohol on those premises, provided that the audience does not exceed 500.
 - a performance of amplified live music between 08.00 and 23.00 on any day, in a church hall, village hall, community hall, or other similar community premises, that is not licensed by a premises licence to sell alcohol, provided that (a) the audience does not exceed 500, and (b) the organiser gets consent for the performance from a person who is responsible for the premises.
 - a performance of amplified live music between 08.00 and 23.00 on any day, at the non-residential premises of (i) a local authority, or (ii) a school, or (iii) a hospital, provided that (a) the audience does not exceed 500, and (b) the organiser gets consent for the performance on the relevant premises from: (i) the local authority concerned, or (ii) the school or (iii) the health care provider for the hospital.
 - Recorded Music: no licence permission is required for:
 - any playing of recorded music between 08.00 and 23.00 on any day on premises authorised to sell alcohol for consumption on those premises, provided that the audience does not exceed 500.
 - any playing of recorded music between 08.00 and 23.00 on any day, in a church hall, village hall, community hall, or other similar community premises, that is not licensed by a premises licence to sell alcohol, provided that (a) the audience does not exceed 500, and (b) the organiser gets consent for the performance from a person who is responsible for the premises.

- any playing of recorded music between 08.00 and 23.00 on any day, at the non-residential premises of (i) a local authority, or (ii) a school, or (iii) a hospital, provided that (a) the audience does not exceed 500, and (b) the organiser gets consent for the performance on the relevant premises from: (i) the local authority concerned, or (ii) the school proprietor or (iii) the health care provider for the hospital.
 - Dance: no licence is required for performances between 08.00 and 23.00 on any day, provided that the audience does not exceed 500. However, a performance which amounts to adult entertainment remains licensable.
 - Cross activity exemptions: no licence is required between 08.00 and 23.00 on any day, with no limit on audience size for:
 - any entertainment taking place on the premises of the local authority where the entertainment is provided by or on behalf of the local authority;
 - any entertainment taking place on the hospital premises of the health care provider where the entertainment is provided by or on behalf of the health care provider;
 - any entertainment taking place on the premises of the school where the entertainment is provided by or on behalf of the school proprietor; and
 - any entertainment (excluding films and a boxing or wrestling entertainment) taking place at a travelling circus, provided that (a) it takes place within a moveable structure that accommodates the audience, and (b) that the travelling circus has not been located on the same site for more than 28 consecutive days.
3. Where taking place in a building or other structure please tick as appropriate (indoors may include a tent).
 4. For example the type of activity to be authorised, if not already stated, and give relevant further details, for example (but not exclusively) whether or not music will be amplified or unamplified.
 5. For example (but not exclusively), where the activity will occur on additional days during the summer months.
 6. For example (but not exclusively), where you wish the activity to go on longer on a particular day e.g. Christmas Eve.
 7. Please give timings in 24 hour clock (e.g. 16.00) and only give details for the days of the week when you intend the premises to be used for the activity.
 8. If you wish people to be able to consume alcohol on the premises, please tick 'on the premises'. If you wish people to be able to purchase alcohol to consume away from the premises, please tick 'off the premises'. If you wish people to be able to do both, please tick 'both'.
 9. Please give information about anything intended to occur at the premises or ancillary to the use of the premises which may give rise to concern in respect of children, regardless of whether you intend children to have access to the premises, for example (but not exclusively) nudity or semi-nudity, films for restricted age groups or the presence of gaming machines.
 10. Please list here steps you will take to promote all four licensing objectives together.
 11. The application form must be signed.
 12. An applicant's agent (for example solicitor) may sign the form on their behalf provided that they have actual authority to do so.
 13. Where there is more than one applicant, each of the applicants or their respective agent must sign the application form.
 14. This is the address which we shall use to correspond with you about this application.
 15. **Entitlement to work/immigration status for individual applicants and applications from partnerships which are not limited liability partnerships:**

A licence may not be held by an individual or an individual in a partnership who is resident in the UK who:

- does not have the right to live and work in the UK; or
- is subject to a condition preventing him or her from doing work relating to the carrying on of a licensable activity.

Any premises licence issued in respect of an application made on or after 6 April 2017 will become invalid if the holder ceases to be entitled to work in the UK.

Applicants must demonstrate that they have an entitlement to work in the UK and are not subject to a condition preventing them from doing work relating to the carrying on of a licensable activity. They do this in one of two ways: 1) by providing with this application copies or scanned copies of the documents listed below (which do not need to be certified), or 2) by providing their 'share code' to enable the licensing authority to carry out a check using the Home Office online right to work checking service (see below).

Documents which demonstrate entitlement to work in the UK

- An expired or current passport showing the holder, or a person named in the passport as the child of the holder, is a British citizen or a citizen of the UK and Colonies having the right of abode in the UK [please see note below about which sections of the passport to copy].
- An expired or current passport or national identity card showing the holder, or a person named in the passport as the child of the holder, is a national of a European Economic Area country or Switzerland.
- A Registration Certificate or document certifying permanent residence issued by the Home Office to a national of a European Economic Area country or Switzerland.
- A Permanent Residence Card issued by the Home Office to the family member of a national of a European Economic Area country or Switzerland.
- A **current** Biometric Immigration Document (Biometric Residence Permit) issued by the Home Office to the holder indicating that the person named is allowed to stay indefinitely in the UK, or has no time limit on their stay in the UK.
- A **current** passport endorsed to show that the holder is exempt from immigration control, is allowed to stay indefinitely in the UK, has the right of abode in the UK, or has no time limit on their stay in the UK.
- A **current** Immigration Status Document issued by the Home Office to the holder with an endorsement indicating that the named person is allowed to stay indefinitely in the UK or has no time limit on their stay in the UK, **when produced in combination with** an official document giving the person's permanent National Insurance number and their name issued by a Government agency or a previous employer.
- A birth or adoption certificate issued in the UK, **when produced in combination with** an official document giving the person's permanent National Insurance number and their name issued by a Government agency or a previous employer.
- A birth or adoption certificate issued in the Channel Islands, the Isle of Man or Ireland **when produced in combination with** an official document giving the

person's permanent National Insurance number and their name issued by a Government agency or a previous employer.

- A certificate of registration or naturalisation as a British citizen, **when produced in combination with** an official document giving the person's permanent National Insurance number and their name issued by a Government agency or a previous employer.
- A **current** passport endorsed to show that the holder is allowed to stay in the UK and is currently allowed to work and is not subject to a condition preventing the holder from doing work relating to the carrying on of a licensable activity.
- A **current** Biometric Immigration Document (Biometric Residence Permit) issued by the Home Office to the holder which indicates that the named person can currently stay in the UK and is allowed to work relation to the carrying on of a licensable activity.
- A **current** Residence Card issued by the Home Office to a person who is not a national of a European Economic Area state or Switzerland but who is a family member of such a national or who has derivative rights of residence.
- A **current** Immigration Status Document containing a photograph issued by the Home Office to the holder with an endorsement indicating that the named person may stay in the UK, and is allowed to work and is not subject to a condition preventing the holder from doing work relating to the carrying on of a licensable activity **when produced in combination with** an official document giving the person's permanent National Insurance number and their name issued by a Government agency or a previous employer.
- A Certificate of Application, **less than 6 months old**, issued by the Home Office under regulation 18(3) or 20(2) of the Immigration (European Economic Area) Regulations 2016, to a person who is not a national of a European Economic Area state or Switzerland but who is a family member of such a national or who has derivative rights of residence.
- Reasonable evidence that the person has an outstanding application to vary their permission to be in the UK with the Home Office such as the Home Office acknowledgement letter or proof of postage evidence, or reasonable evidence that the person has an appeal or administrative review pending on an immigration decision, such as an appeal or administrative review reference number.
- Reasonable evidence that a person who is not a national of a European Economic Area state or Switzerland but who is a family member of such a national or who has derivative rights of residence in exercising treaty rights in the UK including:
 - evidence of the applicant's own identity – such as a passport,
 - evidence of their relationship with the European Economic Area family member – e.g. a marriage certificate, civil partnership certificate or birth certificate, and
 - evidence that the European Economic Area national has a right of permanent residence in the UK or is one of the following if they have been in the UK for more than 3 months:

- (i) working e.g. employment contract, wage slips, letter from the employer,
- (ii) self-employed e.g. contracts, invoices, or audited accounts with a bank,
- (iii) studying e.g. letter from the school, college or university and evidence of sufficient funds; or
- (iv) self-sufficient e.g. bank statements.

Family members of European Economic Area nationals who are studying or financially independent must also provide evidence that the European Economic Area national and any family members hold comprehensive sickness insurance in the UK. This can include a private medical insurance policy, an EHIC card or an S1, S2 or S3 form.

Original documents must not be sent to licensing authorities. If the document copied is a passport, a copy of the following pages should be provided:

- (i) any page containing the holder's personal details including nationality;
- (ii) any page containing the holder's photograph;
- (iii) any page containing the holder's signature;
- (iv) any page containing the date of expiry; and
- (v) any page containing information indicating the holder has permission to enter or remain in the UK and is permitted to work.

If the document is not a passport, a copy of the whole document should be provided.

Your right to work will be checked as part of your licensing application and this could involve us checking your immigration status with the Home Office. We may otherwise share information with the Home Office. Your licence application will not be determined until you have complied with this guidance.

Home Office online right to work checking service

As an alternative to providing a copy of the documents listed above, applicants may demonstrate their right to work by allowing the licensing authority to carry out a check with the Home Office online right to work checking service.

To demonstrate their right to work via the Home Office online right to work checking service, applicants should include in this application their 9-digit share code (provided to them upon accessing the service at <https://www.gov.uk/prove-right-to-work>) which, along with the applicant's date of birth (provided within this application), will allow the licensing authority to carry out the check.

In order to establish the applicant's right to work, the check will need to indicate that the applicant is allowed to work in the United Kingdom and is not subject to a condition preventing them from doing work relating to the carrying on of a licensable activity.

An online check will not be possible in all circumstances because not all applicants will have an immigration status that can be checked online. The Home Office online right to work checking service sets out what information and/or documentation applicants will need in order to access the service. Applicants who are unable to obtain a share code from the service should submit copy documents as set out above.

Consent of individual to being specified as premises supervisor



I
[full name of prospective premises supervisor]

of

[home address of prospective premises supervisor]

hereby confirm that I give my consent to be specified as the designated premises supervisor in relation to the application for

Premises license

[type of application]

by

Pembrokeshire Drinks Ltd

[name of applicant]

relating to a premises licence

N/A New application

[number of existing licence, if any]

for

The Pavillion,
Carew Airfield
Sageston
Tenby SA70 8SX

[name and address of premises to which the application relates]

and any premises licence to be granted or varied in respect of this application made by

Pembrokeshire Drinks Ltd

.....
[name of applicant]

concerning the supply of alcohol at

The Pavillion,
Carew Airfield
Sageston
Tenby SA70 8SX

.....
[name and address of premises to which application relates]

I also confirm that I am entitled to work in the United Kingdom and am applying for, intend to apply for or currently hold a personal licence, details of which I set out below.

Personal licence number

PEMBS/PERS/ [REDACTED]

.....
[insert personal licence number, if any]

Personal licence issuing authority

Pembrokeshire County Council

.....
[insert name and address and telephone number of personal licence issuing authority, if any]

Signed

[REDACTED]

Name (please print)

[REDACTED]

Date

27/01/2020

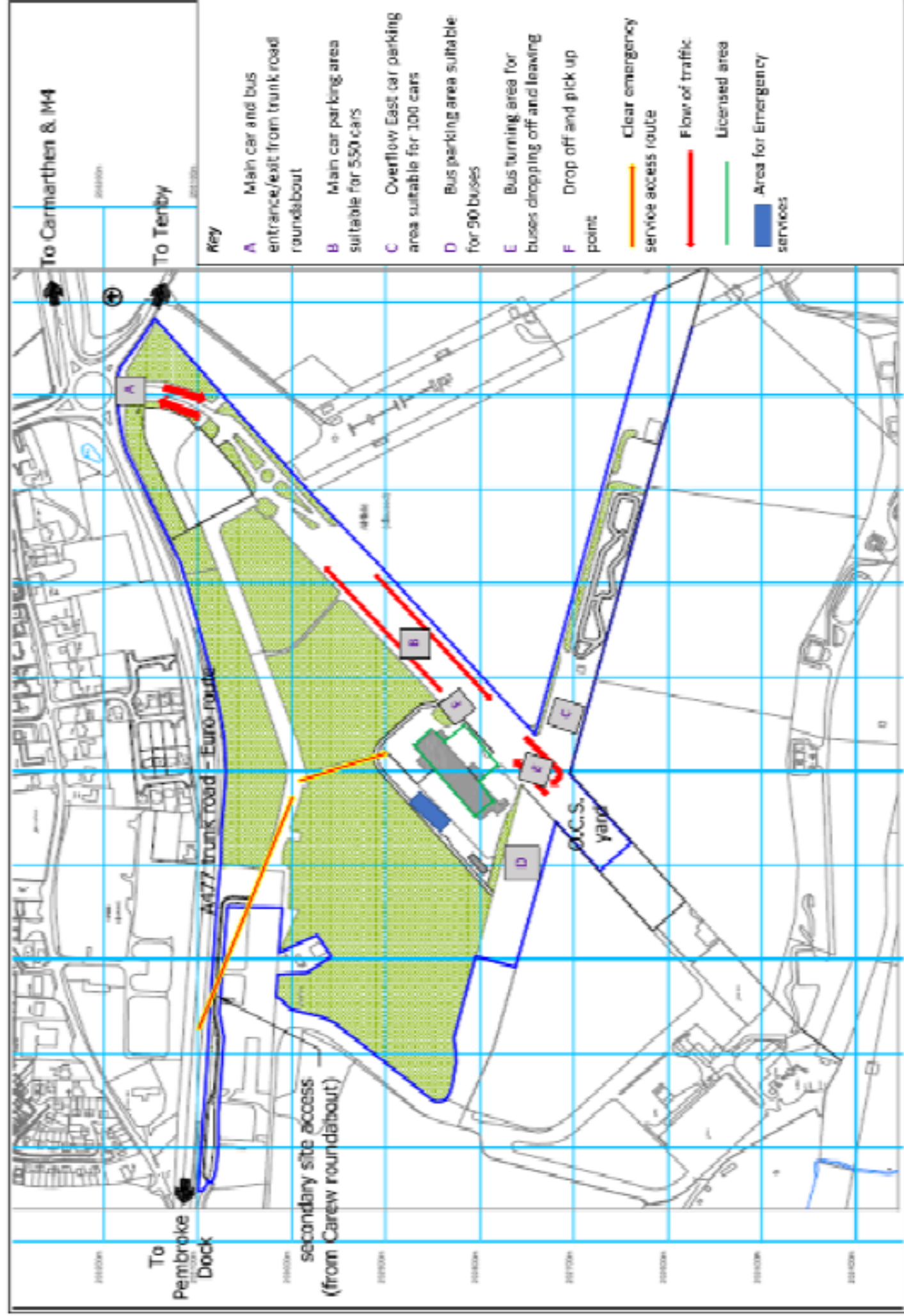

| Key | | FB2 | |
|---|--------------------------|---|---|
|  | Roller Door |  | Fire Box (Powder & water) |
|  | Fire Escape Door |  | Area for sale and consumption of alcohol |
|  | Main Entrance & Exit |  | Area for consumption of alcohol |
|  | Internal Door |  | Area for live & recorded music & performance of dance |
|  | Fire Box (Powder & Foam) | | |

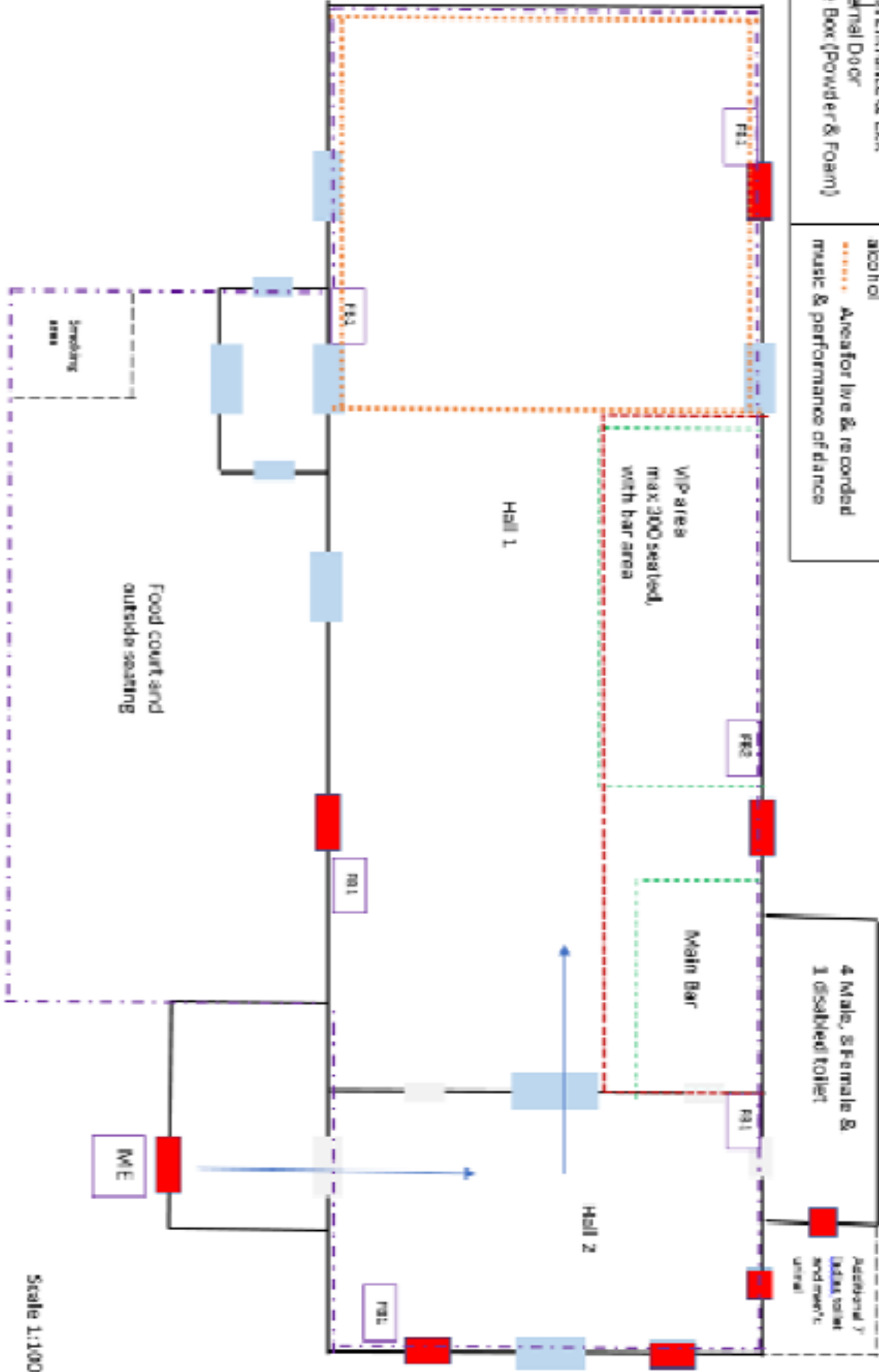

Appendix A

General – all four licensing objectives (b, c, d and e)

As a group of like-minded business people, our aim is to put on two nights of entertainment. Friday night being a reunion party for Withybush hospital and the 999 services. Bringing past and present staff together to reminisce on the years past, look at old photos and enjoy a night of music and socialising.

The Saturday a themed fancy-dress event like no other to be seen in Pembrokeshire. With the hope of a growth event to build on each year.

We are holding a Peaky Blinders themed entertainment evening consisting of 2 actors from the tv series (Fred Farr and Lovelock), 3 live music acts, impressionist, live dance performance and a DJ playing recorded music.

There will be a maximum occupancy figure of 2000 including staff.

The event will be an over 18's ticket only event.

Peaky Blinder attire essential.

There will be a food court area outside the main building, with tendered food suppliers.

The event will run from 6pm – 1am with VIP access from 6pm and general entry at 6:30pm.

We will employ security and trained volunteers to ensure all licensing objectives are met at all times.

Appendix B

The prevention of crime and disorder

Registered SIA security personnel will be on duty during the entire event to effectively police and control the evening.

It is an over 18s only event on both Friday and Saturday, where the guests will be asked for identification on the door. Where any person is suspected to be under the age of 18 identification will be sort in the form of a driving license or passport. If not neither document is produced entry will not be gained.

A number of volunteer stewards will be working in all main areas of the site including site entrance, car parking, drop off points, toilets and general building patrol. An adequate number of registered door persons and stewards will be working to cover the licensed area up to a maximum of 2000 guests.

8 SIA registered door staff will be inside and 13 volunteer stewards will be working outside on car parking, collecting tickets etc.

All stewards will be made fully aware of their responsibilities in the briefing before the event and will receive adequate training where required in particular emergency procedures, incident reporting, car parking and crowd management.

CCTV installed to cover the outside of the building to monitor activity.

All images will be retained for a minimum of 31 days and copies provided to the police and licensing authority upon request.

The whole external area and car park will be well lit with permanent lamp posts, all in good working order, which automatically come on and turn off at dawn and dusk.

Car park marshals will be working to direct and park cars and buses for the duration of the event, to ensure all cars are parked in a safe and orderly manner, allowing access for emergency vehicles.

We will work with the local bus companies in order to limit congestion on the main road and surrounding areas by encouraging patrons to attend the event on bus to cut down on traffic and also at the end of the event it will ensure the swift and safe exit of patrons.

Public address system will be used in the main building to advise patrons when necessary.

Appendix C

Public Safety

To ensure the safety of the public at our event we will have registered door persons and volunteers, who will click guests in and out so we know the number inside the building at one time.

The maximum number of persons permitted to use the licensed premises at any one time, including staff, will not be exceed 2000.

All exits and routes will be kept clear and available throughout the duration of the event. Fire exit doors will be kept clear from any obstruction and easily opened by applying horizontal pressure.

There will be a designated smoking area outside the main building with sand buckets for butts. No person will be allowed to smoke inside the building and no smoking sign will be visible at all points of entry.

No form of heating appliance or lighting involving naked flames, portable paraffin or LPG will be in use at the event.

A separate parking area behind the main building for all emergency vehicles, which will be in close proximity to the main building. Access for emergency vehicles from the designated parking location will be kept clear and free from obstruction at all times.

Sufficiently trained staff will be on duty and a safety briefing will be carried out with all staff and door persons prior to the event start time. During this briefing a code word will be denounced so in the event of a fire or emergency to evacuate the building everyone will know the code word to get the patrons out without alarming them and causing chaos. All staff will be made aware of the efficient running of the premises and the safe evacuation of the premises during this briefing

The duty fire officer will be responsibility for fire prevention measures and for ensuring that all escape routes including exit doors are fully available.

Hangings, curtains, and temporary decorations shall be maintained flame-retarded. Also any upholstered seating in the VIP are shall continue to meet the pass criteria for smouldering ignition source 0, flaming ignition source 1 and crib ignition source 5 when tested in accordance with section 5 of BS5852:1990.

Stage facilities come with their own risk assessment and also public liability insurance.

All electrical installation required on site for lighting, stage, PA should be carried out in a safe manner by a competent, suitably qualified electrical engineer. All wiring must be suitable secured ideally overhead, where any cables are on the surface they must be covered with raps or rubber matting not to create any trip or slip hazards.

The fire brigade shall be called at once to any outbreak or suspected outbreak of fire, however slight and the duty fire officer along with the premise's supervisor.

Fire Aid provision will be suitable for the number of guests attending.

There will be adequate toilet facilities, clearly signed, for male, females and also one disabled toilet facility. These will include the current internal toilet facilities as well as additional portaloos which will be located outside the main building with signs suitably placed.

Car parking stewards and designated bus and car parking areas will be clearly sign posted and also drop off and pick up points to ensure all patrons are safe when arriving and leaving the event. The car park and surrounding areas are all well-lit at night time.

There will be an earlier gate entry time for VIP guests of 6pm which will help reduce and control queuing and rush to enter the event.

The designated premises supervisor or Premises License Holder shall ensure that there is in force during the currency of the license an appropriate Public Liability Insurance Policy relating to the use of the premises for licensable activities.

It is not envisaged that there will be any vehicle ques outside the grounds due to the ample parking facilities available.

Appendix D

The prevention of public nuisance

All doors will be kept closed, other than for access and egress, and also for the toilet facilities.

A nominated representative will be in overall charge of the event who shall receive and respond to any complaint.

shall receive and respond to complaints throughout the duration of the event and will have full control at all times over the sound amplification.

The nominated representative shall have full control at all times over the sound amplification equipment to the main stage. The volume shall be adjusted according to the requirements of Pembrokeshire County Council Licensing Authority.

Noise monitoring will be carried out. Taking the noise levels 3m from the stage and also at the perimeter of the licensed area at 15-minute LEQ intervals.

An adequate number of waste receptacles for use by patrons shall be provided in the main pavilion building and also in the food court outdoor area. The receptacles shall be emptied and the collected refuse disposed of frequently to prevent a build-up.

Prominent, clear notices shall be displayed at the main exit requesting customers to respect the needs of local residents and leave the premises and the area quietly.

Appendix E

The protection of children from harm.

No person under the age of eighteen years allowed at this event.

Registered door person will be at the premises entrance checking that all person are over 18 years of age.

If they are in any doubt identification will be sought in the form of a driving license or passport.

If no identification is produced no entry will be gained.

Sale of alcohol will only be made within the building where the patrons are over 18 years of age.